

► **Ligadores Rápidos (Cabo Rígido)**

► **Conectores Rápidos (Cable Rígido)**

► **Push Wire Connectors (Solide Cable)**

► **Conecteurs Rapides (Cable Solide)**







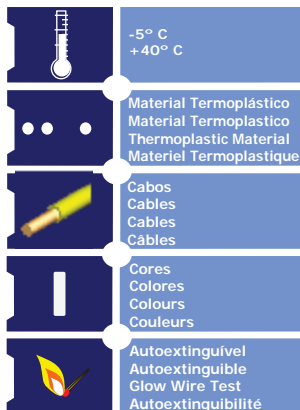

Novos ligadores

Nuevos conectores

New push wire connectors

Nouveaux connecteurs rapides



	Ref.	Amp.	Nº. 	Volts	Ø  (mm <sup>2</sup> )		
	273-102	24	2	450	1-2,5	850°	100
	N273-103	24	3	450	1-2,5	850°	
	N273-104	24	4	450	1-2,5	850°	
	N273-105	24	5	450	1-2,5	850°	

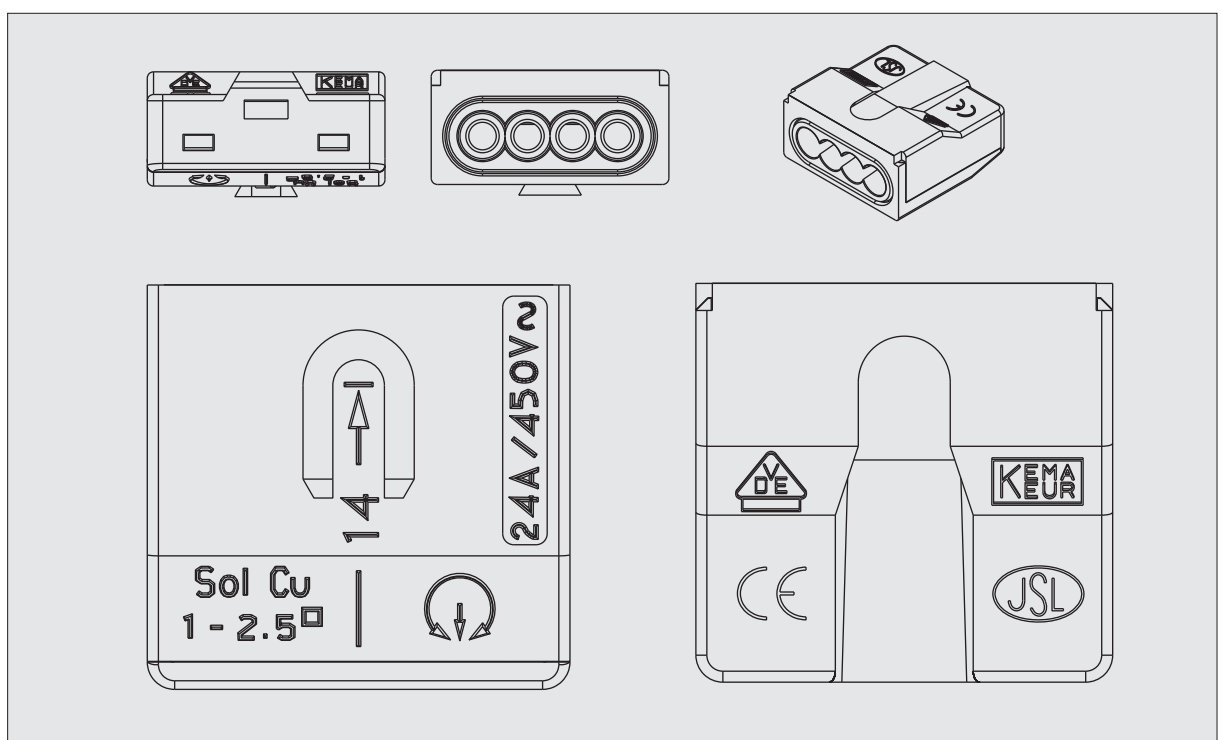

▶ **Ligadores Rápidos**  
(Cabo Flexível e Rígido)

▶ **Conectores Rápidos**  
(Cable Flexible e Rígido)

▶ **Push Wire Connectors**  
(Flexible and Solide wires)

▶ **Conecteurs Rapides**  
(Cable Flexible et Solide)



	-5° C +40° C
	Material Termoplástico Material Termoplastico Thermoplastic Material Materiel Termoplastique
	Cabos Cables Câbles
	Cores Colores Couleurs
	Autoextinguível Autoextinguible Glow Wire Test Autoextinguibilité



	Ref.	Amp.	Nº. Ent.	Volts	Ø / (mm²)	Ø / (mm²)		
	222-3	24	3	450	0,5-2,5	0,5-4	850°	50 / 1050
	222-5	24	5	450	0,5-2,5	0,5-4	850°	25 / 675

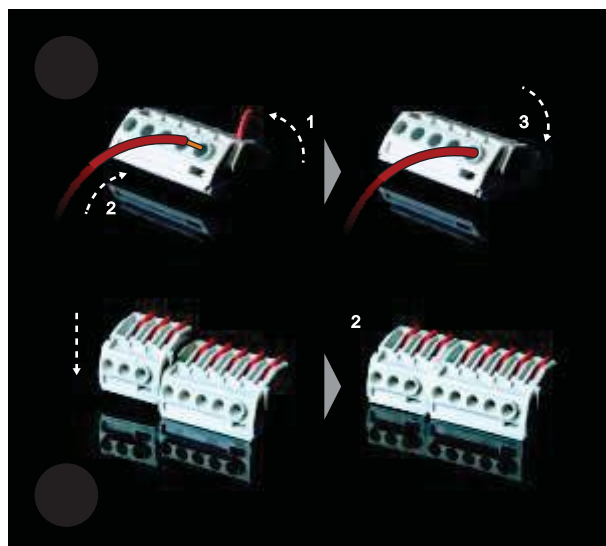
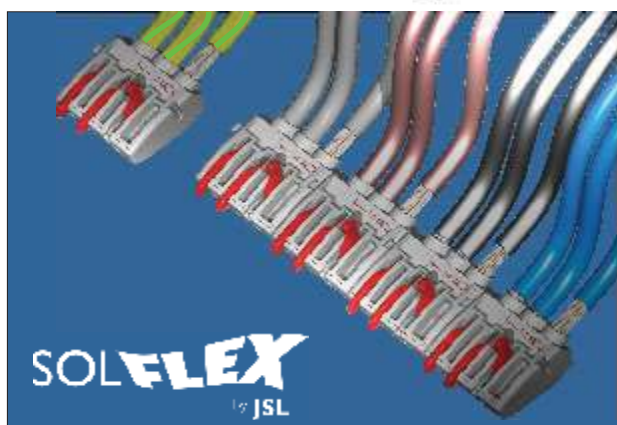
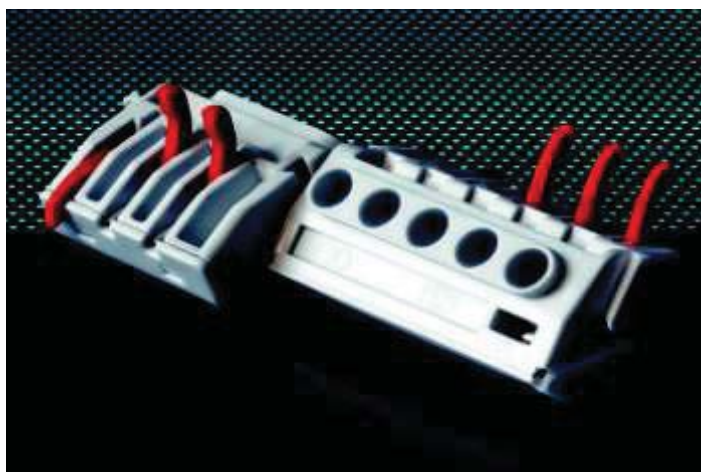

Flex. 0,5mm<sup>2</sup> - 4 mm<sup>2</sup>      -40 °C <> 100 °C  
Rig. 0,5mm<sup>2</sup> - 4 mm<sup>2</sup>      PA6 - V0  
24A 450V



NÃO NECESSITA  
FERRAMENTA

NO NECESSITA  
HERRAMIENTA

DOESN'T NEED  
TOOLS

N'A PAS BESOIN  
D'OUTILS



NÃO MAGOA  
OS DEDOS

NO HACE DAÑOS  
A LOS DEDOS

DOESN'T HURT  
THE FINGERS

NE BLESSE PAS  
LES DOIGTS



LIVRE DE HALOGENÍOS  
E FOSFOROS

LIBRE DE HALOGENOS  
E FOSFURUS

FREE OF HALOGEN  
AND PHOSPHORUS

EXEMPT DE L'HALOGENÈ  
ET DU PHOSPHORE